

ಬೃಹತ್ ಬೆಂಗಳೂರು ಮಹಾನಗರ ಪಾಲಿಕೆ
 ಉಪ ಅರಣ್ಯ ಸಂರಕ್ಷಣಾಧಿಕಾರಿಯವರ ಕಛೇರಿ, ಅನಿಲ್ ಬುಲಿಂಗ್-3,
 ರೂ.ನಂ. 4 ಮತ್ತು 5, ಎನ್.ಆರ್. ಚೌಕ, ಬೆಂಗಳೂರು (5)
 ಸಂಖ್ಯೆ: ಉಪಸಂ/ಪಿಎಂ/1261/2020-21 ದಿನಾಂಕ: 23-02-2021

ಸಾರ್ವಜನಿಕ ಪ್ರಕಟಣೆ

ಈ ಮೂಲಕ ಬೆಂಗಳೂರು ಮಹಾನಗರ ಮತ್ತು ಪುಟ್ಟಮುಕ್ಕಲಿನ ಸಮಸ್ತ ಜನರಿಗೆ ಗಮನಕ್ಕೆ ತರುವುದೇನೆಂದರೆ, ಉಲ್ಲಾಖ ಮತ್ತು ರಸ್ತೆಯ ಮೂಲಕ ಕೆಂಗೇರಿ ಹೊರವಲಯ ರಸ್ತೆಗೆ ಗ್ರೇಡ್ ಸೆಪರೇಟರ್ ನಿರ್ಮಾಣಕ್ಕಾಗಿ, ಈ ಅಗಲೀಕರಣಗೊಳಿಸುವ ಕಾರ್ಯಾಚರಣೆ ಅಡ್ಡಬರುತ್ತಿರುವ ಪುಟ್ಟಗಳನ್ನು ಕಡವೆಗೊಳಿಸಲು ಉದ್ದೇಶಿಸಿದ್ದು ವಿವರಗಳು ಕೆಳಕಂಡಂತಿರುತ್ತವೆ.

ನಿಲಯದ ವಿವರಗಳು
 ಪ್ರಾಯೋಜನೀಯ/ಅರ್ಜಿದಾರರ ಹೆಸರು: ಕಾರ್ಪೊರೇಷನ್ ಅಭಿಯಂತರರು, ಈ ಮತ್ತು ಮೂಲಭೂತ ಸೌಕರ್ಯ, ಉ.ಬಿ.ನಗರ, ಬಿ.ಬಿ.ಎಂ.ಪಿ., ಬೆಂಗಳೂರು. ಮರ ಕೆಡವಿಗೊಳಿಸುವ ಕಾರ್ಯ: Construction of Grade Separator to Kengeri Outer Ring Road across Ulial Main Road ಈ ಅಗಲೀಕರಣಗೊಳಿಸುವ ಕಾರ್ಯಾಚರಣೆ. ಯೋಜನೆಯು ಬರುತ್ತಿರುವ ಪ್ರದೇಶದ ಚಿ.ಎಂ.ಎ. ಐ.ಡಿ.ಎಂ. Construction of Grade Separator to Kengeri Outer Ring Road across Ulial Main Road ಇಲ್ಲಿ ಘಟ ಅಗಲೀಕರಣಗೊಳಿಸುವ ಕಾರ್ಯಾಚರಣೆ ಪ್ರಾ.ಪ್ರ.ಯಲ್ಲಿ ಬರುವ ನಿರ್ದೇಶನಗಳಿಗಾಗಿ
 1) Lat N 12.950225° and Long E 77.4985252° (ಪ್ರಾರಂಭ) 2) Lat N 12.954605° and Long E 77.501364° (ಅಂತ್ಯ). ಯೋಜನಾ ಪ್ರದೇಶದಲ್ಲಿ ಪ್ರಸ್ತುತ ಇರುವ ಮರಗಳು-83 (ಎಂಭತ್ತ ಮೂರು ಮರಗಳು ಮಾತ್ರ). ಮರಗಳ ವಿವರ, ಪಾತಿ, ಪುರಗಳಾದ ಪಾತಿ, ನಕಾಶೆಗಳ ವಿವರಗಳನ್ನು ಉದಯಪಿ ಪೆರೋಲ್ ನಲ್ಲಿ ಮೊಬೈಲಿಗಾಗಿ ಲಭ್ಯವಿರುತ್ತದೆ. (www.bbmp.gov.in) ಅಕ್ಷೇಪಣೆಗಳನ್ನು ಸಾರ್ವಜನಿಕರು ನೇರವಾಗಿ ಇ-ಮೇಲ್/ ಅಥವಾ ಮುಖಾಂತರ ಈ ಕೆಳಕಂಡವರ ಕಛೇರಿಗೆ ಸಲ್ಲಿಸಬಹುದು. ವಿಳಾಸ: ಉಪ ಅರಣ್ಯ ಸಂರಕ್ಷಣಾಧಿಕಾರಿ, (ಪುಟ್ಟಾಧಿಕಾರಿ, ಬಿ.ಬಿ.ಎಂ.ಪಿ.), ನೆಲಮಹಡಿ, ಅನಿಲ್ ಬುಲಿಂಗ್-3, ಎನ್.ಆರ್. ಚೌಕ, ಬೆಂಗಳೂರು-560001, ಇ-ಮೇಲ್: dcfbbmp12@gmail.com ಅಕ್ಷೇಪಣೆಗಳನ್ನು ಸಲ್ಲಿಸಬೇಕಾದ ಅವಧಿ ಈ ಪ್ರಕಟಣೆ ಹೊರಡಿದ ದಿನಾಂಕದಿಂದ 10 ದಿನಗಳಿಗಾಗಿ. (ನೋಟ: ಅಕ್ಷೇಪಣೆಗಳಿಗೆ ಪ್ರಸ್ತಾವಿತ ಯೋಜನೆಗೆ ಮಾತ್ರ ಸಂಬಂಧಿಸುತ್ತದೆ). ಮೇಲ್ಕಂಡ ಪ್ರದೇಶದಲ್ಲಿನ ಮರಗಳನ್ನು ಕೆಡವಿಗೊಳಿಸುವ ಸಂಬಂಧ ಸಾರ್ವಜನಿಕರ ಅಕ್ಷೇಪಣೆ / ಸಲಹೆಗಳನ್ನು ಕಾರ್ಯಾಚರಣೆ ವ್ಯಕ್ತಿ ಸಂರಕ್ಷಣಾ ಕಾಯಿದೆ 1976 ಸೆಕ್ಷನ್ 8(3)(vi) ದೃಢೀಕರಿಸುವ ಸಲಹೆ-ಸೂಚನೆಗಳನ್ನು ನೀಡಲು ಅರ್ಹರಾಗಿರುತ್ತದೆ.

24-2-2021
 ಸಹಿ/- ಉಪ ಅರಣ್ಯ ಸಂರಕ್ಷಣಾಧಿಕಾರಿ (ಪುಟ್ಟಾಧಿಕಾರಿ, ಬಿ.ಬಿ.ಎಂ.ಪಿ.)

ಸಂಖ್ಯೆ: 19. ಇತರರ ಹೆಸರು: ಬಿ.ಬಿ.ಎಂ.ಪಿ. ಇತರ

ಮುಖಾಂತರ
 ಸಾರ್ವಜನಿಕ ಪ್ರಕಟಣೆ
 ಕೈಗೆತ್ತಿಕೊಳ್ಳುವುದು

14x8=112

BRUHAT BANGALORE MAHANAGARA PALIKE
 Office of the Deputy Conservator of Forest, Annex Building-3, Room No. 4 & 5, N.R. Square, Bengaluru.
 No: DCF/PR/1261/2020-21 (7) Dated: 23-02-2021

PUBLIC NOTICE

This is to bring to the notice of all the citizens of Bengaluru City and surrounding areas that it has been proposed to evacuate the trees standing in the way of road widening work for Construction of Grade Separator to Kengeri Outer Ring Road across Ulial Main Road. Details are as under.

Name of Sponsor /Applicant: Executive Engineer, Road and Infrastructure, R.R. Nagar, BBMP, Bengaluru. **Purpose of Tree Evacuation:** Construction of Grade Separator to Kengeri Outer Ring Road across Ulial Main Road. **GPS readings of the project area:** The number of directive datas falling in the limits of road widening works for Construction of Grade Separator to Kengeri Outer Ring Road across Ulial Main Road is 1) Lat N 12.950225° and Long E 77.4985252° (Starting). 2) Lat N 12.954605° and Long E 77.501364° (Ending). Number of trees standing at present in project area 83 (eighty three trees only). Details of trees type and place of trees, map are provided in the bbmp website: www.bbmp.gov.in. **Method of submission of objections:** General public may submit either in person, through e-mail: dcfbbmp12@gmail.com or by post to the Office of the Deputy Conservator of Forest, Annex Building-3, Room No. 4 & 5, N.R. Square, Bengaluru. Time Period for submission of objections: within 10 days from the date of publication of this notification. (Note: Objections should be related only to the proposed project). If any objection or suggestion pertaining to the evacuation of trees at the above mentioned area, suggestions or advice are invited from the general public as per Kamataka Trees Act 1976 Section 8(3)(vii).

Sd/- Deputy Conservator of Forests (Tree Officer, BBMP)

COVID-19. DO NOT PANIC. BE AWARE

Wear Mask, Follow Physical Distancing, Maintain Hand Hygiene

24-2-2021 Deccan Herald

13x8=104



ಬೃಹತ್ ಬೆಂಗಳೂರು ಮಹಾನಗರ ಪಾಲಿಕೆ

ಸಂಖ್ಯೆ: ಉಅಸಂ/ಪಿಆರ್/1761/2020-21

ಉಪ ಅರಣ್ಯ ಸಂರಕ್ಷಣಾಧಿಕಾರಿಯವರ ಕಛೇರಿ
ಬೃಹತ್ ಬೆಂಗಳೂರು ಮಹಾನಗರ ಪಾಲಿಕೆ,
ಎನ್.ಆರ್.ಸ್ಟೇರ್, ಅನೆಕ್ಸ್ ಬಿಲ್ಡಿಂಗ್-3
ಬೆಂಗಳೂರು, ದಿನಾಂಕ: 23.02.2021

ಸಾರ್ವಜನಿಕ ಪ್ರಕಟಣೆ

ಈ ಮೂಲಕ ಬೆಂಗಳೂರು ಮಹಾನಗರ ಮತ್ತು ಸುತ್ತಮುತ್ತಲಿನ ಸಮಸ್ತ ನಾಗರಿಕರ ಗಮನಕ್ಕೆ ತರುವುದೇನೆಂದರೆ,
Construction of Grade Separator to Kengeri Outer ring road across Ullal Main Road ಇಲ್ಲಿ ರಸ್ತೆ
ಅಗಲೀಕರಣಗೊಳಿಸುವ ಕಾಮಗಾರಿಗೆ ಅಡ್ಡ ಬರುತ್ತಿರುವ ಮರಗಳನ್ನು ತೆರವುಗೊಳಿಸಲು ಉದ್ದೇಶಿಸಿದ್ದು ವಿವರಗಳು
ಕೆಳಕಂಡಂತಿರುತ್ತವೆ.

ಪ್ರಾಯೋಜನೆಯ/ಅರ್ಜಿದಾರರ ಹೆಸರು	ಕಾರ್ಯಪಾಲಕ ಅಭಿಯಂತರರು, ರಸ್ತೆ ಮತ್ತು ಮೂಲಭೂತ ಸೌಕರ್ಯ ರಾ.ರಾ.ನಗರ ಬಿಬಿಎಂಪಿ ಬೆಂಗಳೂರು
ಮರ ತೆರವು ಗೊಳಿಸುವ ಉದ್ದೇಶ	Construction of Grade Separator to Kengeri Outer ring road across Ullal Main Road ರಸ್ತೆ ಅಗಲೀಕರಣಗೊಳಿಸುವ ಕಾಮಗಾರಿ
ಯೋಜನೆಯು ಬರುತ್ತಿರುವ ಪ್ರದೇಶದ ಜಿ.ಪಿ.ಎಸ್. ರೀಡಿಂಗ್	Construction of Grade Separator to Kengeri Outer ring road across Ullal Main Road ಇಲ್ಲಿ ರಸ್ತೆ ಅಗಲೀಕರಣಗೊಳಿಸುವ ಕಾಮಗಾರಿಗೆ ವ್ಯಾಪ್ತಿಯಲ್ಲಿ ಬರುವ ನಿರ್ದೇಶಾಂಕಗಳು. 1. Lat N 12.950225" and Long E 77.4985252" (ಪ್ರಾರಂಭ) 2. Lat N 12.954605" and Long E 77.501364" (ಅಂತಿಮ)
ಯೋಜನಾ ಪ್ರದೇಶದಲ್ಲಿ ಪ್ರಸ್ತುತ ಇರುವ ಮರಗಳು-83 (ಎಂಭತ್ತ ಮೂರು ಮರಗಳು ಮಾತ್ರ) ಪಟ್ಟಿ ಲಗತ್ತಿಸಿದೆ	ಮರಗಳ ವಿವರ, ಜಾತಿ, ಮರಗಳಿರುವ ಜಾಗ, ನಕಾಶೆಗಳ ವಿವರಗಳನ್ನು ಬಿಬಿಎಂಪಿ ವೆಬ್ ಸೈಟ್‌ನಲ್ಲಿ ಮಾಹಿತಿಗಾಗಿ ಒದಗಿಸಲಾಗಿದೆ. (www.bbmp.gov.in)
ಆಕ್ಷೇಪಣೆಗಳನ್ನು ಸಲ್ಲಿಸುವ ವಿಧಾನ (ಸಾರ್ವಜನಿಕರು ನೇರವಾಗಿ/ಇ-ಮೇಲ್/ಅಂಚೆ ಮುಖಾಂತರ ಈ ಕೆಳಸಹಿದಾರರ ಕಛೇರಿಗೆ ಸಲ್ಲಿಸಬಹುದು)	ವಿಳಾಸ: ಉಪ ಅರಣ್ಯ ಸಂರಕ್ಷಣಾಧಿಕಾರಿ, (ವೃಕ್ಷಾಧಿಕಾರಿ, ಬಿಬಿಎಂಪಿ) ನೆಲಮಹಡಿ, ಅನೆಕ್ಸ್ ಬಿಲ್ಡಿಂಗ್ -3, ಎನ್.ಆರ್. ವೃತ್ತ, ಬೆಂಗಳೂರು - 560001. Email ID: dcfbbmp12@gmail.com
ಆಕ್ಷೇಪಣೆಗಳನ್ನು ಸಲ್ಲಿಸಬೇಕಾದ ಅವಧಿ	ಈ ಪ್ರಕಟಣೆ ಹೊರಡಿಸಿದ ದಿನಾಂಕದಿಂದ 10 ದಿನಗಳೊಳಗಾಗಿ ಸೂಚನೆ: ಆಕ್ಷೇಪಣೆಗಳು ಪ್ರಸ್ತಾವಿತ ಯೋಜನೆಗೆ ಮಾತ್ರ ಸಂಬಂಧಿಸಿರಬೇಕು.

ಮೇಲ್ಕಂಡ ಪ್ರದೇಶದಲ್ಲಿನ ಮರಗಳನ್ನು ತೆರವುಗೊಳಿಸುವ ಸಂಬಂಧ ಸಾರ್ವಜನಿಕರ ಆಕ್ಷೇಪಣೆ / ಸಲಹೆಗಳಿದ್ದಲ್ಲಿ ಕರ್ನಾಟಕ ವೃಕ್ಷ ಸಂರಕ್ಷಣಾ ಕಾಯಿದೆ 1976 ಸೆಕ್ಷನ್ 8(3)(vii) ಪ್ರಕಾರ ಸಲಹೆ-ಸೂಚನೆಗಳನ್ನು ನೀಡಲು ಆಹ್ವಾನಿಸಲಾಗಿದೆ.

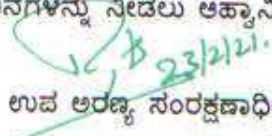
ಉಪ ಅರಣ್ಯ ಸಂರಕ್ಷಣಾಧಿಕಾರಿ,
(ವೃಕ್ಷಾಧಿಕಾರಿ, ಬಿಬಿಎಂಪಿ)
ಬೆಂಗಳೂರು



RUHAT BANGALORE MAHANAGARA PALIKE

No: DCF/PR/ 126 /2020-21

Office of the
Deputy Conservator of Forests
Bruhat Bangalore Mahanagara Palike
N.R.Squre Annex Biliding-3
Bangalore, dated: 23.02.2020

Public Notification

This is to bring to the notice of all BBMP and surrounding citizens of Bengaluru that Construction of Grade Separator to Kengeri Outer ring road across Ullal Main Road Bengaluru. Details are given below:

Name of the Project/Applicant	Executive Engineer Road Infrastructure, R.R.Nagara BBMP	
Purpose for removal of tree(s)	Construction of Grade Separator to Kengeri Outer ring road across Ullal Main Road BBMP limits	
Description of the area with clear demarcation of boundaries or with GPS readings	Executive Engineer Major Road Widening BBMP with following co-ordinates. 1. Lat N 12.950225" and Long E 77.4985252" (Starting Point) 2. Lat N 12.954605" and Long E 77.501364" (End Point)	
Enumeration of trees 1. Total no trees standing in the project area -83 (Eighty three)	List enclosed	Description of Trees, species, location, Area Map etc are uploaded in the website of BBMP for information of all. (www.bbmp.gov.in)
Mode of communication of comments (Public can send their comments either by E-mail / Post / Hand)	Address: The Deputy Conservator of Forests (Tree Officer, BBMP) Ground Floor, Annex-3 Building, N.R. Square, Bangalore-560001. Email ID: dcfbbmp12@gmail.com	
Deadline for filing objections	Ten (10) days from the date of Publication of this notification *Comments should be relevant and specific to the project	

In this background suggestions and objections invited from all citizens in terms of section 8 (3)(vii) of The Karnataka Preservation of Tree Act 1976.

Deputy Conservator of Forests
(Tree Officer, BBMP)
Bangalore

BRUHAT BANGALORE MAHANAGARA PALIKE

Construction of Grade Separator at Kengeri Outer Ring Road Across Ullal Main Road

Trees on Govt Property (i.e, Footpath and Median)

SL No	Tree No	Name of Tree	Tree Girth (M)	Tree Height (m)	Remarks
1	1	Peltophorum Tree	1.50	2.20	
2	2	Honge Tree	0.20	1.40	
3	3	Mahogany Tree	0.55	0.85	
4	4	Mahogany Tree	0.40	2.50	
5	5	BiliJaali	0.40	2.20	
6	6	Mahogany Tree	0.65	1.80	
7	7	Huvarasi Tree	0.45	0.90	
8	8	Mahogany Tree	0.20	2.30	
9	9	Mahogany Tree	0.35	1.50	
10	10	Huvarasi Tree	0.40	1.80	
11	11	Huvarasi Tree	0.25	1.80	
	11(a)		0.25	1.80	
12	12	Mahogany Tree	0.43	0.20	
13	13	Atti	0.40	0.50	
14	14	Huvarasi Tree	0.35	1.50	
15	15	Mahogany Tree	0.30	2.80	
16	16	Mahogany Tree	0.18	2.00	
17	17	Rain Tree	1.10	3.00	
	17(a)		1.05	3.00	
18	18	Honge Tree	0.15	0.90	
19	19	Huvarasi Tree	0.25	1.30	
20	20	Huvarasi Tree	0.10	0.20	
21	21	Peltophorum Tree	0.85	1.30	
22	22	Peltophorum Tree	1.65	0.82	
23	23	Peltophorum Tree	0.70	1.50	
24	24	Neem Tree	0.50	3.00	
25	25	Huvarasi Tree	0.30	0.70	
26	26	Mahogany Tree	0.35	1.40	
27	27	Honge Tree	0.30	1.30	
28	28	Neem Tree	0.90	2.20	
29	29	Honge Tree	0.40	0.80	
30	30	Mahogany Tree	0.40	1.70	

31	31	Mahogany Tree	0.35	1.70	
32	32	Rain Tree	0.60	2.80	
33	33	Subabul tree	0.45	2.50	
34	34	Huvarasi Tree	0.75	1.00	
35	35	Honge Tree	0.10	0.70	
36	36	Mahogany Tree	0.37	1.60	
37	37	Neem Tree	0.80	4.00	
38	38	Mahogany Tree	0.70	1.60	
39	39	Mahogany Tree	0.46	4.30	
40	40	Mahogany Tree	0.45	3.00	
41	41	Honge Tree	0.60	0.50	
42	42	Dalichand tree	0.50	2.20	
43	43	Mahogany Tree	0.55	2.35	
44	44	Dalichand tree	0.60	2.10	
45	45	Mahogany Tree	0.70	4.50	
46	46	Dalichand tree	0.55	4.50	
47	47	Dalichand tree	0.50	5.00	
48	48	Mahogany Tree	0.35	2.50	
49	49	Neem Tree	0.70	4.50	
50	50	Dalichand tree	0.40	1.50	
51	51	Mahogany Tree	0.10	2.00	
52	52	Dalichand tree	0.15	2.50	
53	53	Neem Tree	0.60	2.50	
54	54	Dalichand tree	0.35	4.00	
55	55	Neem Tree	0.80	3.50	
56	56	Neem Tree	1.15	4.00	
57	57	Mahogany Tree	0.40	4.00	
58	58	Neem Tree	1.10	3.00	
59	59	Dalichand tree	0.40	7.50	
60	60	Dalichand tree	0.45	3.50	
61	61	Dalichand tree	0.45	2.50	
62	62	Mahogany Tree	0.45	5.00	
63	63	Arali	0.25	1.20	
64	64	Dalichand tree	0.50	4.00	
65	65	Mahogany Tree	0.60	4.50	
66	66	Neem Tree	1.50	1.50	
67	67	Arali	0.30	3.00	
68	68	Mahogany Tree	0.30	4.00	
69	69	Dalichand tree	0.50	2.50	

70	70	Mahogany Tree	0.50	3.50	
71	71	Neem Tree	1.20	4.00	
72	72	Mahogany Tree	0.40	3.50	
73	73	Tamarind Tree	0.90	2.30	
74	74	Mahogany Tree	0.60	2.00	
75	75	Mahogany Tree	0.60	2.50	
76	76	Huvarasi Tree	0.65	1.60	
77	77	Mahogany Tree	0.60	4.50	
78	78	Huvarasi Tree	0.30	2.50	
79	79	Neem Tree	1.20	3.00	
80	80	Arali	2.60	4.50	
81	81	Neem Tree	1.10	4.00	
82	82	Dalichand tree	0.90	3.00	
	82(a)		0.60	3.00	
83	83	Rain Tree	1.60	3.50	

By G.R.
Dt. R.F.O.

G. R. O.
R.F.O.

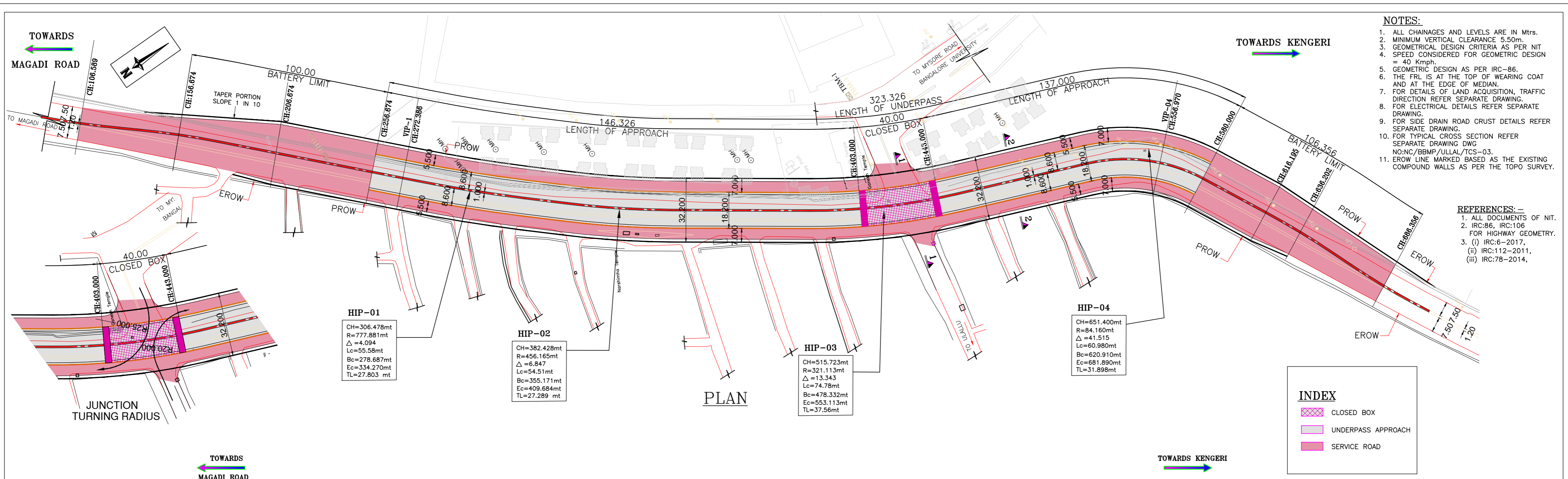

- NOTES:**
1. ALL CHAINAGES AND LEVELS ARE IN Mtrs.
 2. MINIMUM VERTICAL CLEARANCE 5.50m.
 3. GEOMETRICAL DESIGN CRITERIA AS PER NIT
 4. SPEED CONSIDERED FOR GEOMETRIC DESIGN = 40 Kmph.
 5. GEOMETRIC DESIGN AS PER IRC-86.
 6. THE FRL IS AT THE TOP OF WEARING COAT AND AT THE EDGE OF MEDIAN.
 7. FOR DETAILS OF LAND ACQUISITION, TRAFFIC DIRECTION REFER SEPARATE DRAWING.
 8. FOR ELECTRICAL DETAILS REFER SEPARATE DRAWING.
 9. FOR SIDE DRAIN ROAD CRUST DETAILS REFER SEPARATE DRAWING.
 10. FOR TYPICAL CROSS SECTION REFER SEPARATE DRAWING DWG NO:NC/BMP/JULLAL/TCS-03.
 11. EROW LINE MARKED BASED AS THE EXISTING COMPOUND WALLS AS PER THE TOPO SURVEY.

- REFERENCES: -**
1. ALL DOCUMENTS OF NIT.
 2. IRC:86, IRC:106 FOR HIGHWAY GEOMETRY.
 3. (i) IRC:6-2017, (ii) IRC:112-2011, (iii) IRC:78-2014.

INDEX

- CLOSED BOX
- UNDERPASS APPROACH
- SERVICE ROAD

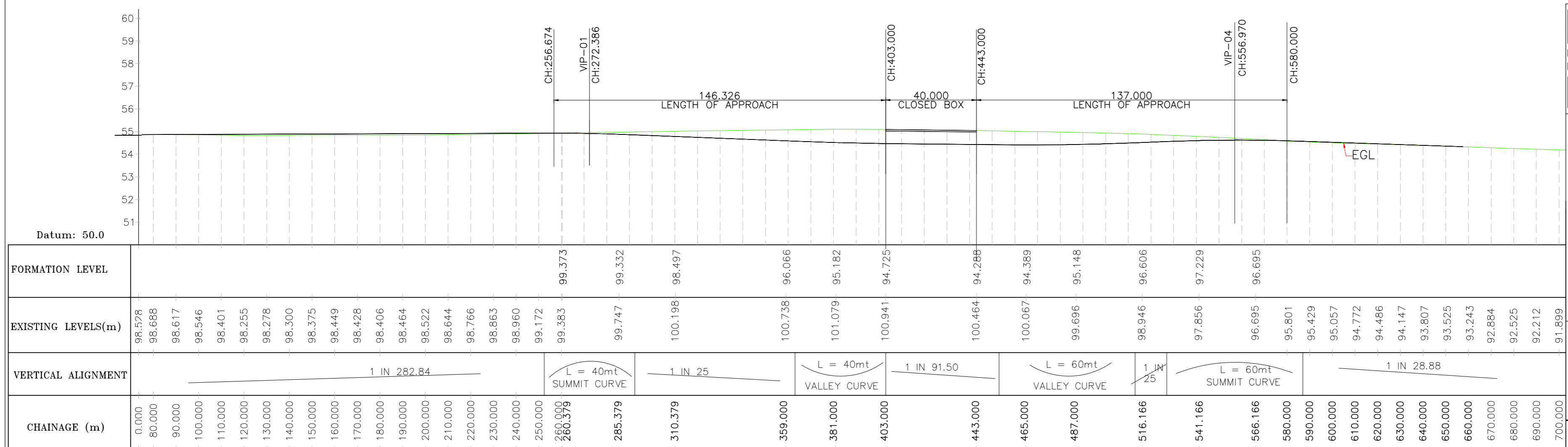

LONGITUDINAL SECTION
(SCALE: 1:1.)

REV	DATE	DESCRIPTION	SIGN
R1	04.10.19	ALIGNMENT SHIFTED TOWARDS JNCE & DESIGN CHANGED TO COVERCUT METHOD TO CUT&COVER METHOD	

DWG NO : NC/BMP/JULLAL/GAD-01 R1

TITLE:
PLAN AND PROFILE FOR UNDERPASS ALIGNMENT

PROJECT:
PREPARATION OF DETAILED PROJECT REPORT (DPR) FOR WORK OF CONSULTANCY SERVICES FOR PREPARATION OF DPR FOR THE WORK OF CONSTRUCTION OF GRADE SEPARATORS KENGERI OUTER RING ROAD ACROSS ULLAL MAIN ROAD

CLIENT:
 BRUHAT BANGALORE MAHANAGARA PALIKE

CONSULTANTS:
 NAGESH CONSULTANTS
2, 6 TH CROSS, ASHOKNAGAR, BSK I STAGE, BANGALORE - 560 050

DRAWN BY : SHYAM DESIGNED BY : SHYAM
CHECKED BY : H.S.MANJUNATH.
DATE : 04-10-2019
SHEET SIZE (A1) : SHEET SCALE = 1:100
APPROVED BY : B.V.NAGESH

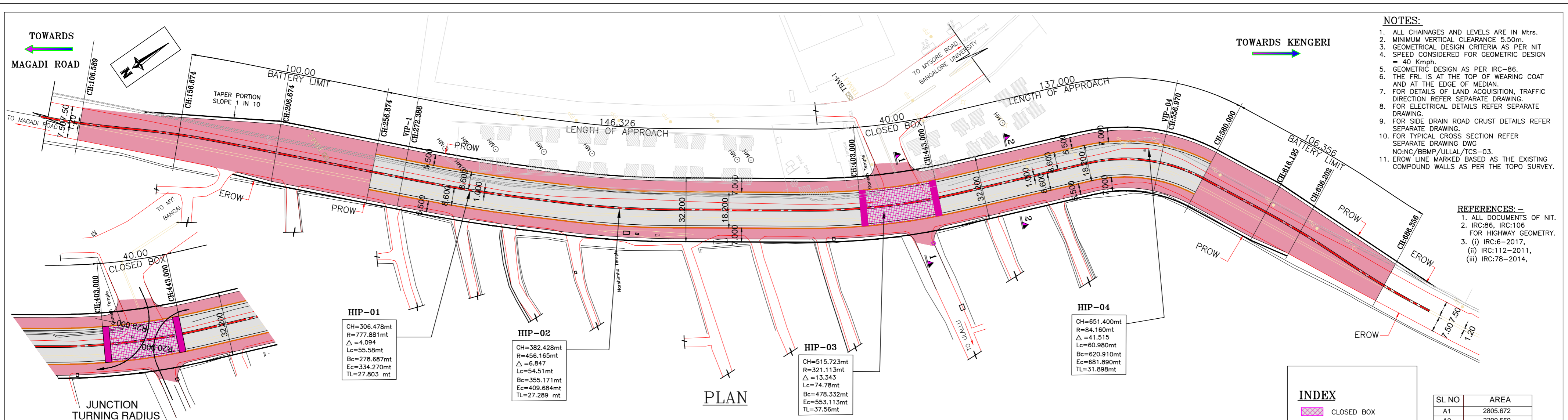

- NOTES:**
1. ALL CHAINAGES AND LEVELS ARE IN Mtrs.
 2. MINIMUM VERTICAL CLEARANCE 5.50m.
 3. GEOMETRICAL DESIGN CRITERIA AS PER NIT
 4. SPEED CONSIDERED FOR GEOMETRIC DESIGN = 40 Kmph.
 5. GEOMETRIC DESIGN AS PER IRC-86.
 6. THE FRL IS AT THE TOP OF WEARING COAT AND AT THE EDGE OF MEDIAN.
 7. FOR DETAILS OF LAND ACQUISITION, TRAFFIC DIRECTION REFER SEPARATE DRAWING.
 8. FOR ELECTRICAL DETAILS REFER SEPARATE DRAWING.
 9. FOR SIDE DRAIN ROAD CRUST DETAILS REFER SEPARATE DRAWING.
 10. FOR TYPICAL CROSS SECTION REFER SEPARATE DRAWING DWG NO:NC/BM/PULLAL/LGAD-03.
 11. EROW LINE MARKED BASED AS THE EXISTING COMPOUND WALLS AS PER THE TOPO SURVEY.

- REFERENCES: -**
1. ALL DOCUMENTS OF NIT.
 2. IRC:86, IRC:106 FOR HIGHWAY GEOMETRY.
 3. (i) IRC:6-2017, (ii) IRC:112-2011, (iii) IRC:78-2014.

INDEX

	CLOSED BOX
	UNDERPASS APPROACH
	SERVICE ROAD

SL NO	AREA
A1	2805.672
A2	2290.559
A3	29.003
A4	3.694
TOTAL	5128.928

* FOR DETAILS REFER SEPARATE DRAWING

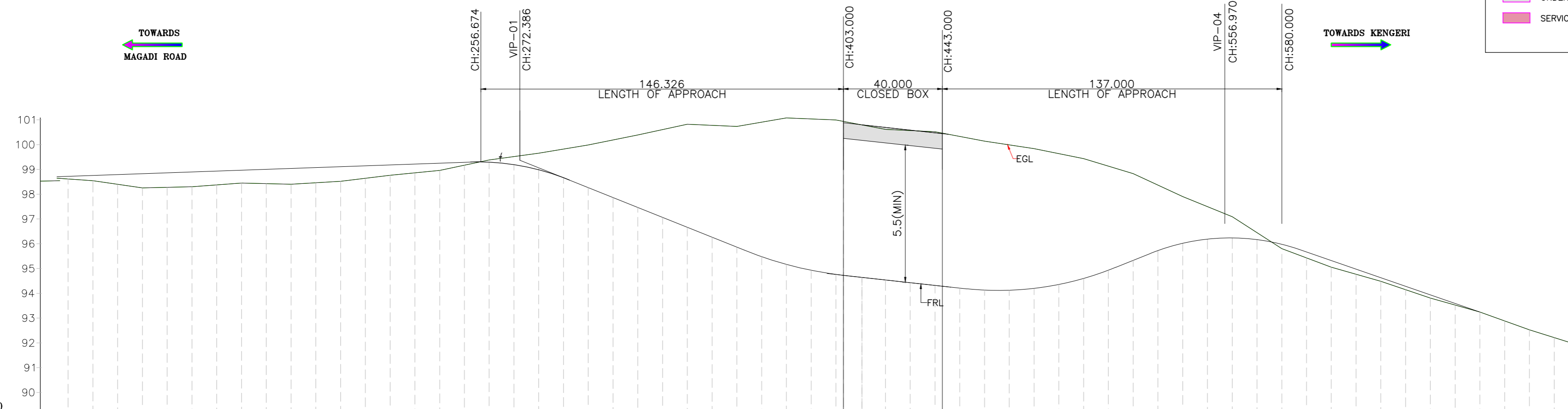

CHAINAGE (m)	EXISTING LEVELS(m)	FORMATION LEVEL	VERTICAL ALIGNMENT
0.000	96.528		
90.000	98.617	98.723	
100.000	98.546	98.794	
110.000	98.401	98.829	
120.000	98.255	98.865	
130.000	98.278	98.900	
140.000	98.300	98.936	
150.000	98.375	98.971	
160.000	98.449	99.006	
170.000	98.428	99.042	
180.000	98.406	99.077	
190.000	98.464	99.112	
200.000	98.522	99.148	
210.000	98.644	99.183	
220.000	98.766	99.218	
230.000	98.863	99.254	
240.000	98.960	99.289	
250.000	99.172	99.289	
260.000	99.383	99.289	
270.000	99.520	99.188	
280.000	99.657	98.981	
290.000	99.824	98.662	
300.000	99.990	98.263	
310.000	100.190	97.864	
320.000	100.390	97.464	
330.000	100.606	97.064	
340.000	100.822	96.664	
350.000	100.778	96.264	
360.000	100.734	95.864	
370.500	100.909	95.480	
380.000	101.083	95.168	
390.500	101.041	94.931	
400.000	100.998	94.762	
410.000	100.809	94.643	
410.500	100.620	94.539	
420.000	100.571	94.430	
430.000	100.521	94.321	
440.000	100.332	94.211	
450.000	100.143	94.127	
460.000	99.990	94.122	
470.000	99.837	94.197	
480.000	99.636	94.355	
485.500	99.435	94.598	
490.000	99.133	94.932	
500.000	98.830	95.331	
505.500	98.367	95.725	
510.000	97.903	96.019	
520.000	97.499	96.186	
530.000	97.094	96.234	
540.000	96.448	96.166	
550.000	95.801	95.977	
560.000	95.429	95.666	
570.000	95.057	95.320	
580.000	94.772	94.974	
590.000	94.486	94.628	
600.000	94.147	94.282	
610.000	93.807	93.935	
620.000	93.525	93.589	
630.000	93.243	93.243	
640.000	92.884		
650.000	92.525		
660.000	92.212		
670.000			
680.000			
690.000			

LONGITUDINAL SECTION
(SCALE: H 1:1000, V 1:200.)

REV	DATE	DESCRIPTION	SIGN
R1	04.10.19	ALIGNMENT SHIFTED TOWARDS INCE & DESIGN CHANGED TO COVERGUT METHOD TO CUT&COVER METHOD	

DWG NO : NC/BM/PULLAL/LGAD-01

TITLE : **PLAN AND PROFILE FOR UNDERPASS ALIGNMENT**

PROJECT : **PREPARATION OF DETAILED PROJECT REPORT (DPR) FOR WORK OF CONSULTANCY SERVICES FOR PREPARATION OF DPR FOR THE WORK OF CONSTRUCTION OF GRADE SEPARATORS KENGERI OUTER RING ROAD ACROSS ULLAL MAIN ROAD**

CLIENT : **BRUHAT BANGALORE MAHANAGARA PALIKE**

CONSULTANTS : **NAGESH CONSULTANTS**
2, 6 TH CROSS, ASHOKNAGAR, BSK I STAGE, BANGALORE - 560 050

DRAWN BY : SHYAM | DESIGNED BY : SHYAM

CHECKED BY : | H.S.MANJUNATH.

DATE : | 04-10-2019

SHEET SIZE (A1) : | SHEET SCALE = 1:100

APPROVED BY : | B.V.NAGESH

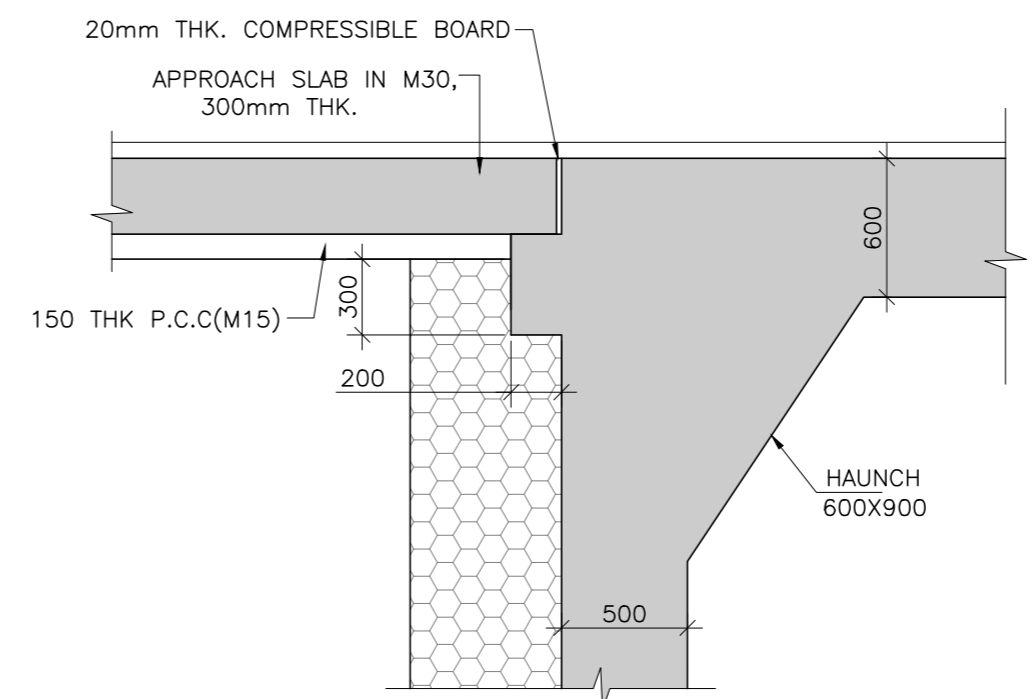
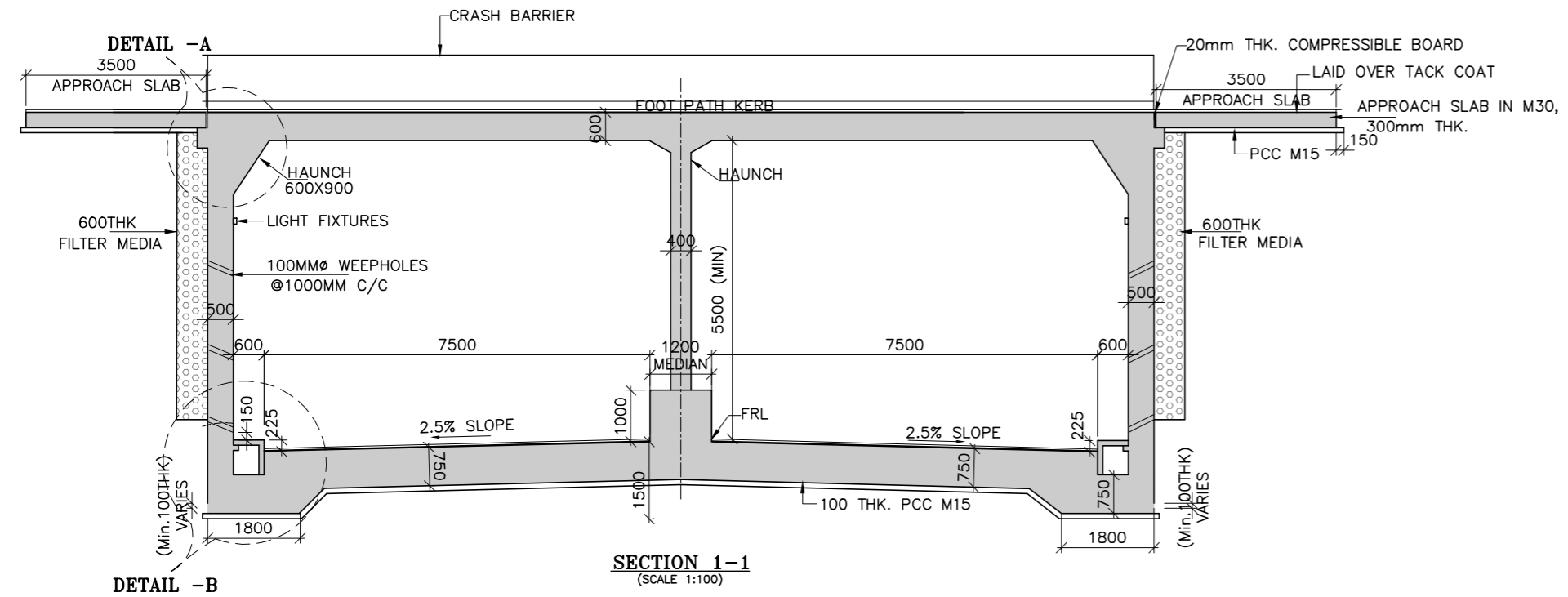

- NOTES:**
1. ALL DIMENSIONS ARE IN MILLIMETRES AND LEVELS ARE IN METERS UNLESS OTHERWISE STATED.
 2. DO NOT SCALE THE DIMENSIONS, FOLLOWED ONLY WRITTEN DIMENSIONS.
 3. SHARP EDGES OF CONCRETE SHALL BE CHAMFERED.
 4. READ WITH DRAWING NOS, DWG NO : NC/BBMP/ULLAL/GAD-01

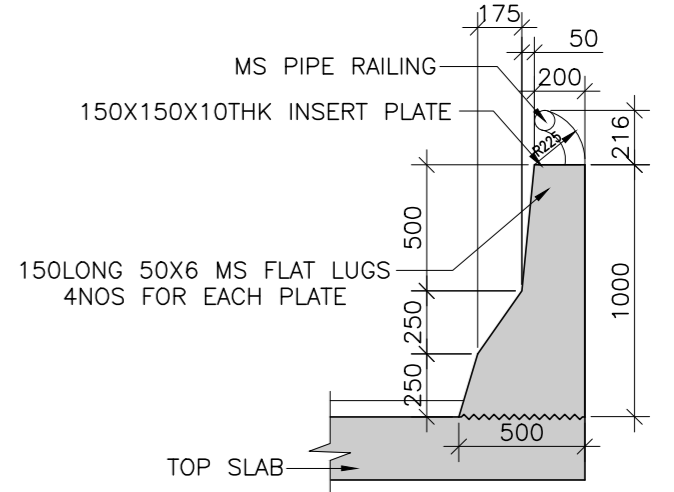

RCC CRASH BARRIER DETAIL
(GRADE OF CONCRETE M40)
(SCALE: (1:25))

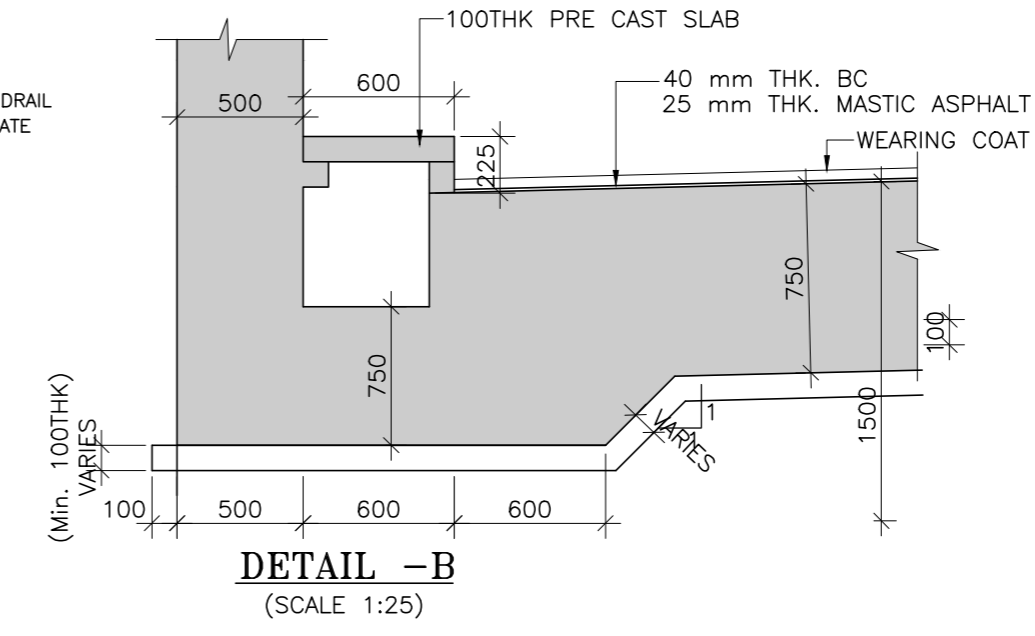
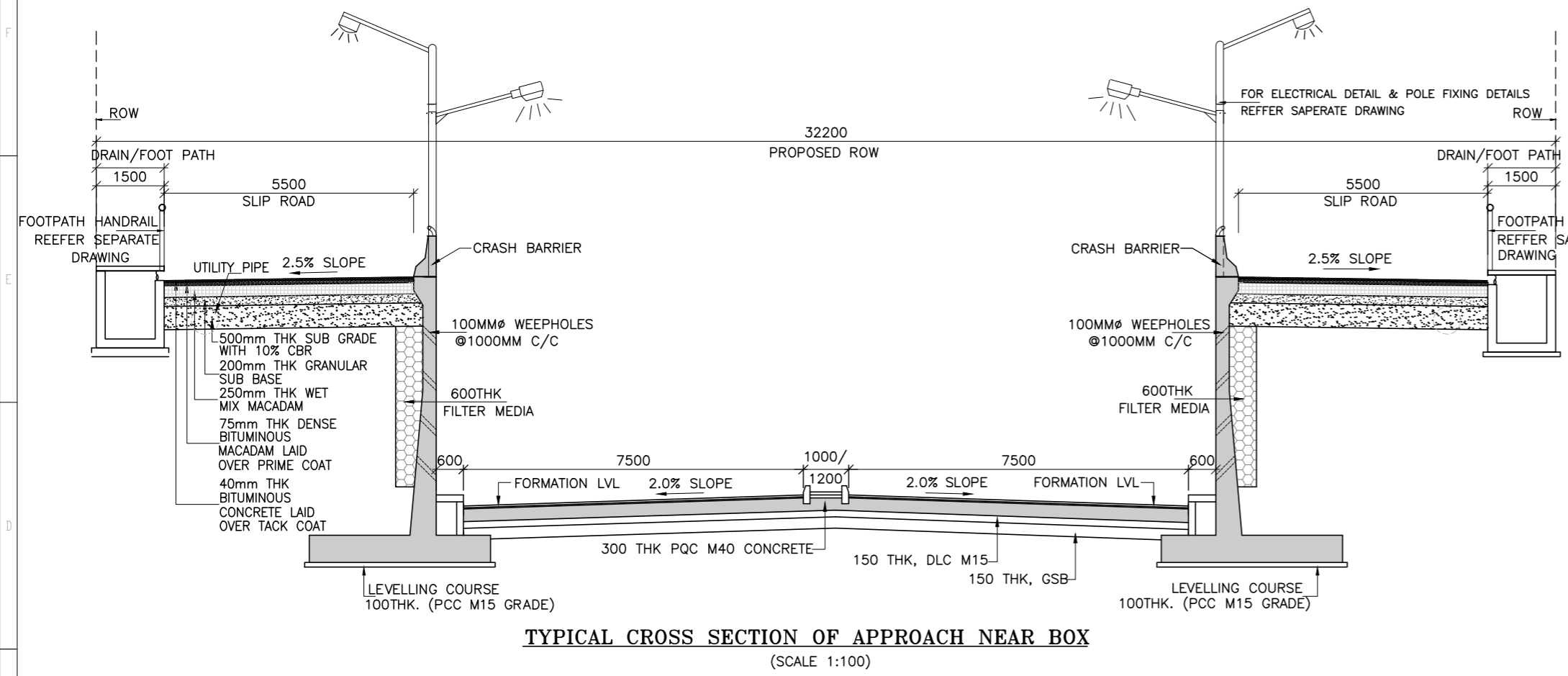

DETAIL - B
(SCALE 1:25)

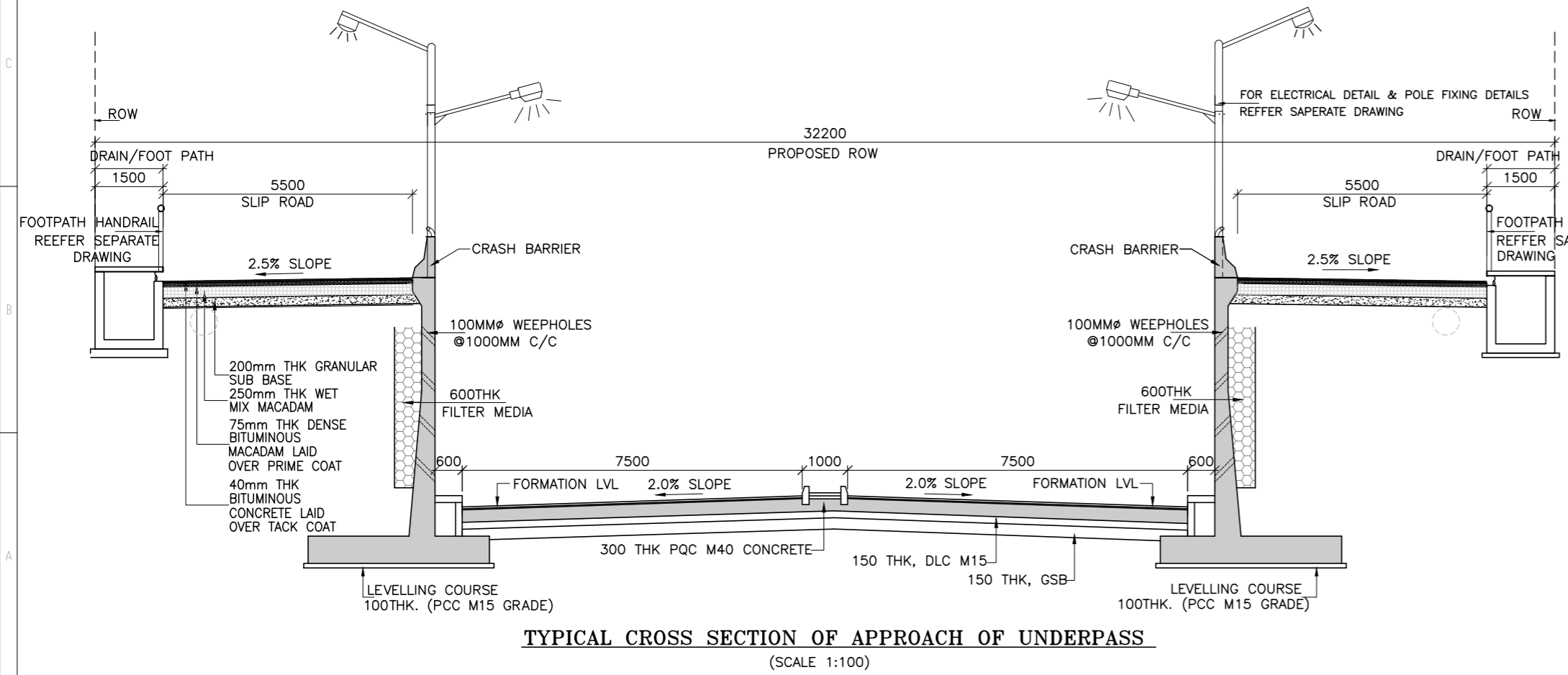

REV.	DATE	DESCRIPTION	SIGN

DWG NO : NC/BBMP/ULLAL/TCS-03

TITLE : TYPICAL CROSS SECTIONS

PROJECT :
PREPARATION OF DETAILED PROJECT REPORT (DPR) FOR WORK OF CONSULTANCY SERVICES FOR PREPARATION OF DPR FOR THE WORK OF CONSTRUCTION OF GRADE SEPARATORS KENGERI OUTER RING ROAD ACROSS ULLAL MAIN ROAD

CLIENT :

BRUHAT BANGALORE MAHANAGARA PALIKE

CONSULTANTS :
NAGESH CONSULTANTS
 # 2, 6 TH CROSS,
 ASHOKNAGAR, BSK I STAGE,
 BANGALORE - 560 050

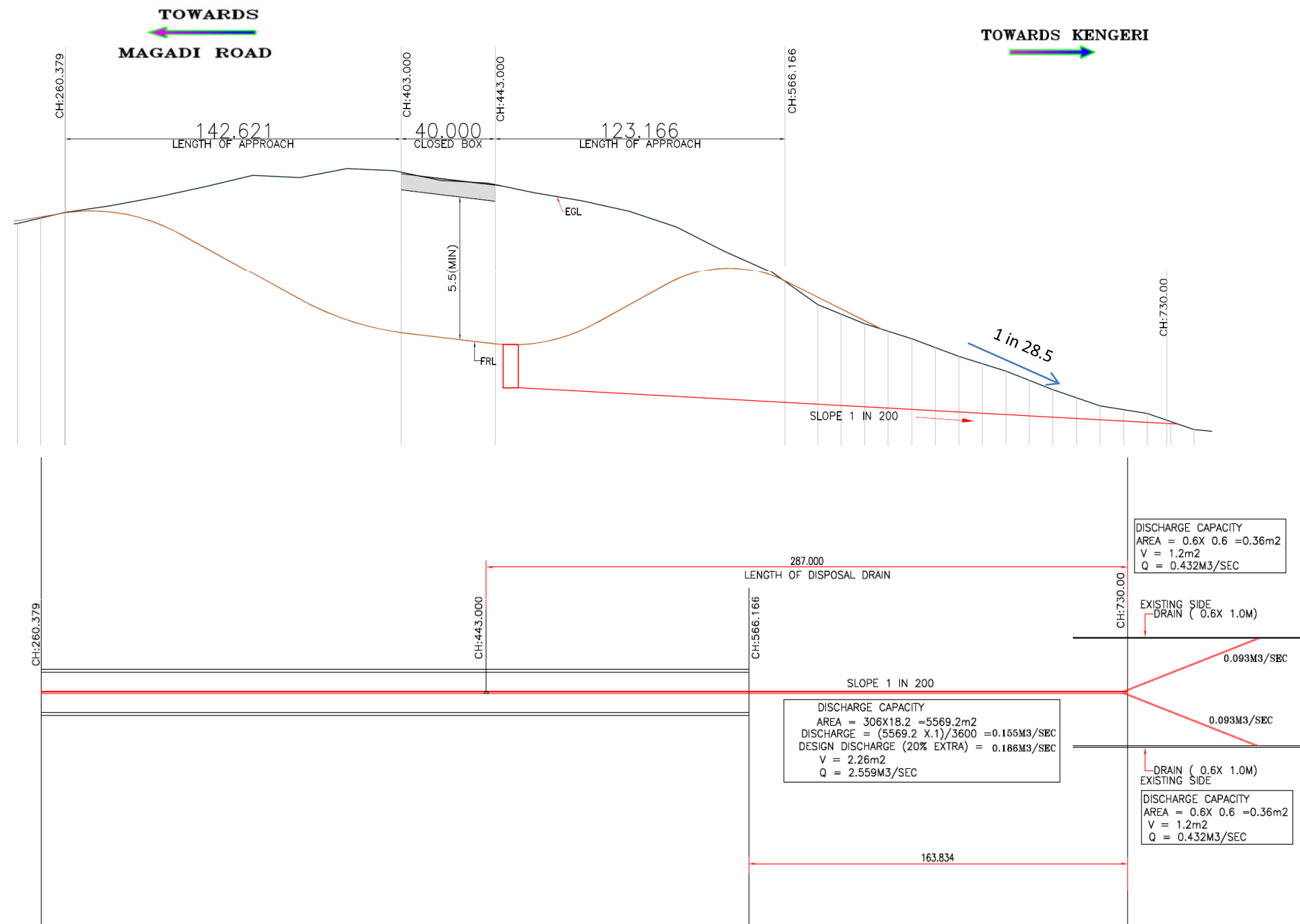

DRAWN BY : SHARADA	DESIGNED BY : SHYAM
CHECKED BY :	H.S.MANJUNATH.
DATE :	04.10.19
SHEET SIZE (A1) :	SHEET SCALE = 1:100
APPROVED BY	B.V.NAGESH

Disposal Drain details



- NOTES:**
1. ALL CHAINAGES AND LEVELS ARE IN Mtrs.
 2. MINIMUM VERTICAL CLEARANCE 5.50m.
 3. GEOMETRICAL DESIGN CRITERIA AS PER NIT
 4. SPEED CONSIDERED FOR GEOMETRIC DESIGN = 40 Kmph.
 5. GEOMETRIC DESIGN AS PER IRC-86.
 6. THE FRL IS AT THE TOP OF WEARING COAT AND AT THE EDGE OF MEDIAN.
 7. FOR DETAILS OF LAND ACQUISITION, TRAFFIC DIRECTION REFER SEPARATE DRAWING.
 8. FOR ELECTRICAL DETAILS REFER SEPARATE DRAWING.
 9. FOR SIDE DRAIN ROAD CRUST DETAILS REFER SEPARATE DRAWING.
 10. FOR TYPICAL CROSS SECTION REFER SEPARATE DRAWING DWG NO:NC/BMPP/ULLAL/TCS-03.
 11. EROW LINE MARKED BASED AS THE EXISTING COMPOUND WALLS AS PER THE TOPO SURVEY.

- REFERENCES: -**
1. ALL DOCUMENTS OF NIT.
 2. IRC:86, IRC:106 FOR HIGHWAY GEOMETRY.
 3. (i) IRC:6-2017, (ii) IRC:112-2011, (iii) IRC:78-2014.

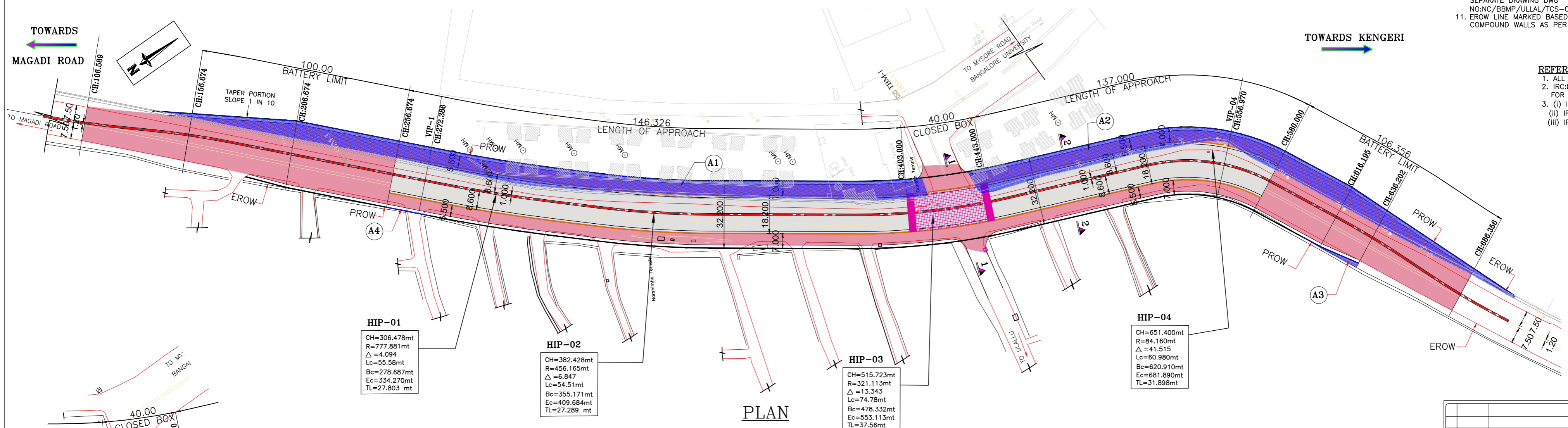

HIP-01
 CH=306.478mt
 R=777.881mt
 Δ =4.094
 Lc=55.58mt
 Bc=278.687mt
 Ec=334.270mt
 TL=27.803 mt

HIP-02
 CH=382.428mt
 R=456.165mt
 Δ =6.847
 Lc=54.51mt
 Bc=355.171mt
 Ec=409.684mt
 TL=27.289 mt

HIP-03
 CH=515.723mt
 R=321.113mt
 Δ =13.343
 Lc=74.78mt
 Bc=478.332mt
 Ec=553.113mt
 TL=37.56mt

HIP-04
 CH=651.400mt
 R=84.160mt
 Δ =41.515
 Lc=60.980mt
 Bc=620.910mt
 Ec=681.890mt
 TL=31.898mt

PLAN

INDEX

	CLOSED BOX
	UNDERPASS APPROACH
	SERVICE ROAD

SL NO	AREA
A1	2805.672
A2	2290.559
A3	29.003
A4	3.694
TOTAL	5128.928

* FOR DETAILS REFER SEPARATE DRAWING

REV	DATE	DESCRIPTION	SIGN
R1	04.10.19	ALIGNMENT SHIFTED TOWARDS INCE & DESIGN CHANGED TO COVER/SLIP METHOD TO CUT/COVER METHOD	

DWG NO : NC/BMPP/ULLAL/GAD-01

TITLE :
 PLAN AND PROFILE
 FOR UNDERPASS ALIGNMENT

PROJECT :
 PREPARATION OF DETAILED PROJECT REPORT (DPR) FOR WORK OF CONSULTANCY SERVICES FOR PREPARATION OF DPR FOR THE WORK OF CONSTRUCTION OF GRADE SEPARATORS KENGERI OUTER RING ROAD ACROSS ULLAL MAIN ROAD

CLIENT :
BRUHAT BANGALORE MAHANAGARA PALIKE

CONSULTANTS :
NAGESH CONSULTANTS
 # 2, 6 TH CROSS,
 ASHOKNAGAR, BSK I STAGE,
 BANGALORE - 560 050

DRAWN BY : SHYAM DESIGNED BY : SHYAM

CHECKED BY : H.S.MANJUNATH.

DATE : 04-10-2019

SHEET SIZE (A1) : SHEET SCALE = 1:100

APPROVED BY : B.V.NAGESH